



## Description

P/Q600 Solenoids are available in a variety of base size with a number of boot options to provide environmental protection. We can customize the P/Q600 Solenoids to meet specific requirements. P/Q600 options include various voltages, mounts, rods, boots, spring returns, connectors and plunger surface finishes. P/Q600 Solenoids are often used for Throttle control and fuel shutdown applications. P600 (pull type) and Q600 (push type) are built to withstand high temperature and high vibration environments.

## Applications

- Lawn and garden equipment
- Compressors
- Generators
- Construction equipment

## Specifications

**P/Q600 Solenoid Family** P= Pull Type Q= Push Type

Series	Max Stroke	Max Force	A Inches [mm]	B Inches [mm]	C Inches [mm]
P/Q610	1	15	2.20 [55.8]	1.63 [41.4]	Length Variable
P/Q612	1	23	2.40 [61.0]	1.88 [47.8]	Length Variable
P/Q613	1 1/2	20	3.5 [88.9]	2.00 [50.8]	Length Variable

## General Specifications

Series	Pull Current	Hold Current	Pull Force @1"	Hold Force at Rated Voltage and 25°C	Shipping Weight
P/Q610 - 12 Volt	48 Amps	1 Amps	15 lbs (67 Newtons)	20 lbs (89 Newtons)	1.3 lbs
P/Q610 - 24 Volt	25 Amps	.48 Amp	15 lbs (67 Newtons)	20 lbs (89 Newtons)	1.3 lbs
P/Q612 - 12 Volt	60 Amps	.9 Amp	23 lbs (102 Newtons)	43 lbs (191 Newtons)	1.7 lbs
P/Q612 - 24 Volt	30 Amps	.5 Amp	23 lbs (102 Newtons)	43 lbs (191 Newtons)	1.7 lbs
P/Q613 - 12 Volt	70 Amps	.88 Amp	21 lbs (94 Newtons)	40 lbs (178 Newtons)	2.7 lbs
P/Q613 - 24 Volt	36 Amps	.48 Amp	21 lbs (94 Newtons)	40 lbs (178 Newtons)	2.7 lbs



## Production Dimension

### P610 Series

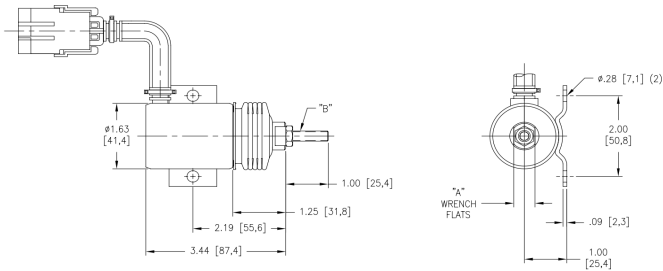

### Q610 Series

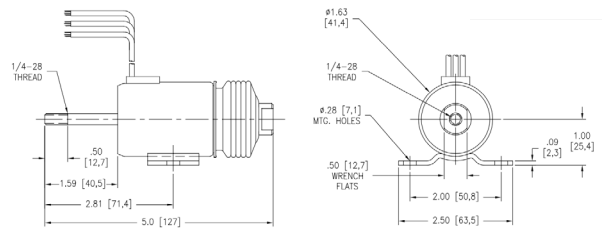

### P612 Series

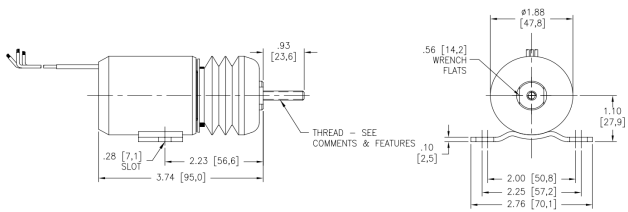

### Q612 Series

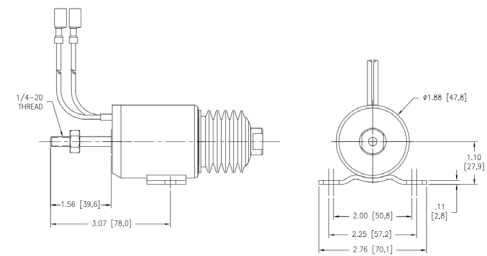

### P613 Series

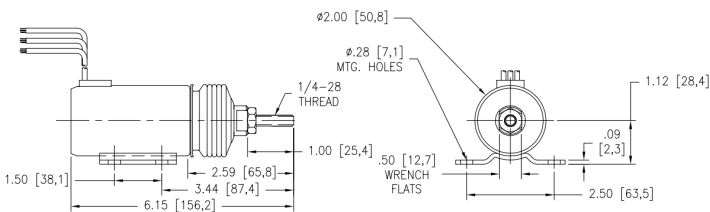

### Q613 Series

